

LIMITED WARRANTY

Dealer, warrants to the original consumer purchaser that each new Minikote Pro Laminator which proves defective in materials or workmanship within the applicable warranty period will be repaired or, at our option, replaced without charge upon its return as outlined below. The applicable warranty shall be one year from date of purchase. "Original consumer purchaser" means the purchaser who first purchased the product covered by this warranty other than for purpose of resale.

Liability for breach of any warranty express or implied shall be limited to the repair or replacement, at dealer, option, of the defective item. Dealer shall not be liable for damages arising out of, or in connection with the use or performance of any product. Any implied warranty shall be limited in duration to the duration of this warranty. Some states do not allow limitations on how long an implied warranty lasts for the exclusion or limitation of consequential damages, so the above limitation may not apply to you.

There are no consumer serviceable parts in the Minikote Pro Laminator. If you require service under this Warranty, contact your dealer to obtain Return Authorization (RA), pack the product in its original packaging (or request the same from Technical Service when requesting the RA), and include a description of the malfunction and proof of date of purchase. Technical Service will arrange for the Minikote Pro Laminator to be picked up by a freight company. Failure to return in original packaging could void this warranty.

The Warranty extends to and is enforceable only by the original consumer purchaser, and only for the period which the product remains in the possession of the original equipment purchaser. This Warranty does not cover any defect or malfunction due to the use of faulty non- Minikote Pro Laminator materials, unreasonable use or abuse of the machine, or failure to provide reasonable and necessary maintenance. This Warranty gives you specific legal rights and you may have other rights, which vary, from state to state.

D&K
1795 Commerce Drive
Elk Grove Village, IL 60007

Toll Free: 800-632-2314
Technical Service: 847-956-0160
www.dkgroup.com
Hrs: 8:00am-5:00pm (CST)

OWNERS MANUAL

D&K Minikote Pro



Important Information

Save Your Carton! Laminators are shipped in special cartons to protect them from damage. Please save your cartons in case the laminator ever requires servicing.

Remove the laminator from its box by grasping the housings and pulling up. Do not use rollers or shafts as handles- this could cause damage.

The power supply cord should be unplugged from the wall outlet when it is to be unused for a long period of time.

This manual is provided as an **Operator’s Manual** and covers most situations you will encounter while using your laminator. It is not a Technical Service manual. For technical assistance beyond what this manual provides, contact D&K at:

D & K
80 Bond St.
Elk Grove Village, IL 60007
Ph: (800) 632-2314
www.dkgroup.com

This information is provided as a guide and does not constitute a representation or warranty, expressed or implied, relating to the suitability or fitness for a particular application or otherwise create guarantees of product performance. In all cases, customers should independently determine the suitability of products for their specific application before use. Manufacturer reserves the right to make changes any time.

MiniKote Pro

201800

| | | | | | |
|----|-----------|--|----------|-----------------------------|---------------------------------|
| 1 | 707905 | Feed Table, ARL, 27" | 73 | 610026 | Spacer 1/4 x 1.032 Steel |
| 2 | 601345 | Screw #8-32 x 1/2" | 105 | 690918 | Key |
| 3 | 707284 | Left Feed Guide, Black Powder | 104 | 707873 | Chassis |
| 4 | 603340 | Nut, 8-32 Tinnerman | | BHCS | 8.32 x 3/8 |
| 5 | 707942 | Heat Guard 27", MK2 28 9/16 | | 708146 | Clip, Bushing Retainer |
| 6 | 650801 | 27" Pull Roll | | 610035 | Spacer 1/4 x 58 |
| 7 | 707901 | Upper Roll Shaft ARL-27" | | 6021 | PPHS 10-32 x 1/2 |
| 8 | 709573 | 27" Rubber Roll | | 12030 | Nut, SS Tooth Washer |
| 9 | 707902 | Lower Roll Shaft ARL-27" | | 610513 | Cover - Jones Socket |
| 10 | 707998 | Display Lens, MK2G2 | | | |
| 11 | 707852 | Bracket Block, MK2 | | | |
| 12 | 707851 | Switch Mntg Bracket, MK2 | | | |
| 13 | 707944 | Keyswitch Bracket, MK2 | | | |
| 14 | 707588Blk | Left Housing, MK2 | 907002 | Hand Held Slitter Assembly | |
| 15 | 707587Blk | Right Housing, MK2 | 74 | 707001 | Hand Held Slitter Housing |
| 16 | 611077 | 6-19 x 5/8 Plastite 48-2 Thread | 75 | 707002 | Slitter Hook Blade |
| 17 | 801923 | Motor Control KBIC-11 PMCL | 76 | 707003 | Slitter Blade Cover |
| 18 | 611020 | Screw, 6-32X3/8" W/Patch Phil | 77 | 600781 | Screw, 2-56x3/16" Self Tapping |
| 19 | 601112 | 6-32X1/2 RH, Nylon Slotted | 78 | 707004 | Slitter Magnet, Pressure Sens. |
| 20 | 801988 | Fuseholder, Molded Base | | | |
| 21 | 802448 | Fuse, 8A/250V Slo Blo | 79 | 654081 | Bushing, Front Rollers |
| 22 | 611027 | Screw, 6-32 X 5/16 Phil Pan Hd | 80 | 654095 | Bushing, Upper Roll AV |
| 24 | 801939 | Power Cords 16-3 Miller #E9006 | | | |
| 25 | 802104 | Motor, 90V DC | 81 | 911129 | IR Sensor |
| 26 | 908026 | Chain | 82 | 600290 | Screw, 8-32 X 3/16, Set |
| 27 | 801207 | Sprocket 25B19 1/2 10-32 AV | | | |
| 28 | 801208 | Sprocket 25B30 | 83 | 709573 | Heated Nip Roller |
| 29 | 801205 | Sprocket 25B23 1/2, 10-32 AV | 84 | 920503 | Thermal Cutout, MK2 SA |
| 30 | 600350 | Screw, 10-32 X 3/8 Set | 85 | 802065 | Heater, 650W |
| 31 | 707399 | Tension Knob, AV-OEM | 103 | 707813 | Pull Roller Lifter |
| 32 | 802160 | Compress Spring LC-098K-00-M/W | 86 | 707814 | Pull Roller Lift Pin |
| 33 | 707406 | Friction Plate AV-OEM | 87 | 707871 | Pressure Bracket, Lt. |
| 34 | 707409 | Friction Disc, Black | | | |
| 35 | 707415 | Friction Stud Molded - OEM | 89 | 654090 | Bushing - Lower Roll AV Delrin |
| 36 | 707985 | Electrical Insulator | 90 | 707870 | Pressure Bracket - Rt. |
| 37 | 911120 | G1, Sensor Board, MK2G1 | | | |
| 38 | 911132 | G2, Main Board, Mk2G2 110V. | 94 | 801977 | Rubber Feet 2580 |
| 39 | 911125 | G2, Display Board, MK2G2, Less Buttons | 95 | 600055 | Screw, 10-32 x 5/8 SHC |
| 40 | 610421 | Black Button Cap, MK2G2, Req. 11 | 96 | 620430 | Wire Bushing SB625-500 |
| 41 | 610422 | Red Button Cap, MK2G2, Req. 1 | | | |
| 42 | 604960 | Nylon Washer .163X.377X.050 Thk | 89 | 654090 | Bushing - Lower Roll AV Delrin |
| 43 | 601100 | Screw, 6-32X1/4 Pan Head | 94 | 801977 | Rubber Feet 2580 |
| 44 | 708015 | G2, DisplayLabel, MPL27 | 95 | 600055 | Screw, 10-32 x 5/8 SHC |
| 45 | 707309 | Counter Label, MK2G2 | 96 | 620430 | Wire Bushing SB625-500 |
| 46 | 707922 | G2, Switch Label, MK2G2 | | | |
| 47 | 610033 | Spacer 1/4 OD x .171 ID x .125 | 907411LP | Lower Supply Roll SA 1"-27" | |
| 48 | 611021 | 6-32x 1/2 RH, Nylon Slotted | 907411UP | Upper Supply Roll SA 1"-27" | |
| 49 | 690917 | Keyswitch | 98 | 604400 | Rivet GSMD42S |
| 50 | 600966 | Screw, 1/4X1.25, Shoulder, 10-32 | 99 | 707685 | 1" Supply Roll Plug - ARL, Seal |
| 52 | 620112 | Strain Relief, Heyco 3213/3 | 100 | 707690 | 1" Supply Roll "D" Plug, ARL |
| 55 | 600080 | Screw, 10-32 X 1 1/4 SHC | 101 | 707706 | 1" Supply Roll Tubing ARL 27" |
| 56 | 601090 | Screw, 6-32X3/16 Pan Head | 102 | 707710 | Torsion Spring 1" Extrusion |
| 57 | 707907 | Lower Idler Roll/ARL-27" | | | |
| 58 | 603356 | Nut, 1/4-20 Hex w/Nylon Insert | | | |
| 59 | 610040 | Spacer 1/4X3/4 | | | |
| 62 | 604955 | Washer .265X.500X.015 Thk | | | |
| 63 | 604840 | Washer, 1/4 Split Lock | | | |
| 64 | 600680 | Screw, 10-32X1/2 Button Head | | | |
| 65 | 600711 | Screw, 10-32X1.5 SHC | | | |
| 66 | 707062 | Idler Roll Dowels | | | |
| 67 | 604815 | Washer, #8 Ext Star Lock | | | |
| 68 | 601115 | Screw, 8-32x1/4 Pan Head | | | |
| 69 | 802155 | Pressure Spring | | | |
| 70 | 707211 | Pressure Adjust Screw | | | |
| 71 | 605021 | Washer, Zinc, .203X.625X.016 | | | |
| 72 | 708147 | Clip, Bushing, Retaining | | | |

EXPLODED VIEW

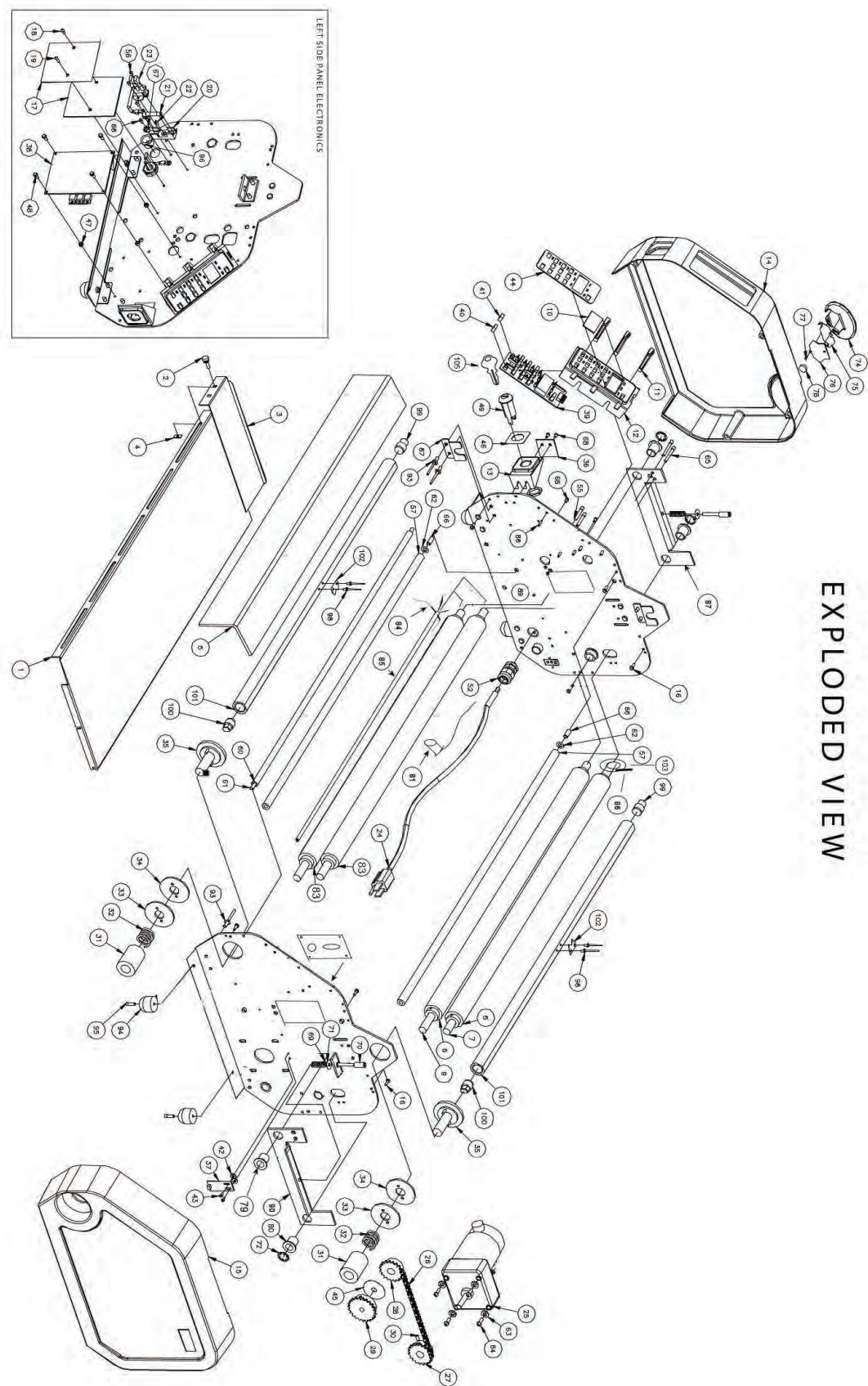

CONTENTS

Section Index

Specs 1

Important Safeguards 2

General Diagrams 3 - 4

I. Unpacking 5

II. Information About Laminating Film 5

III. Operating

 A. Control Panel 5 - 6

 B. Loading Film: 1" Mandrel 7

 C. Threading Film 8

 D. Laminating 9

 E. Supply Roll Tension Adjustment 9 - 10

 F. Mounting 10

V. Maintaining the Minikote

 A. Care and Cleaning 11

 B. Specific Troubleshooting Guide 12

 C. Removing a Wrap Around 12 - 13

Appendix A

 Replacing the Hand Held Cutter Blades 13

Wiring Diagrams 14

Exploded Diagram 15

Parts List 16

Warranty 17

SPECIFICATIONS

| | |
|-------------------------------|---------------------------|
| Height | 15”(381 mm) |
| Width | 34” |
| Depth (with feed tray) | 20” |
| Net Weight..... | 66 lbs. |
| Shipping Weight | 72 lbs. |
| Capacity..... | 27” |
| Electrical..... | 120V AC, 60Hz, 1400w |
| Maximum Speed..... | 9.5 fpm (feet per minute) |
| Maximum Temperature | 300 F |
| Maximum Board Thickness | 1/4” |

WIRING DIAGRAM

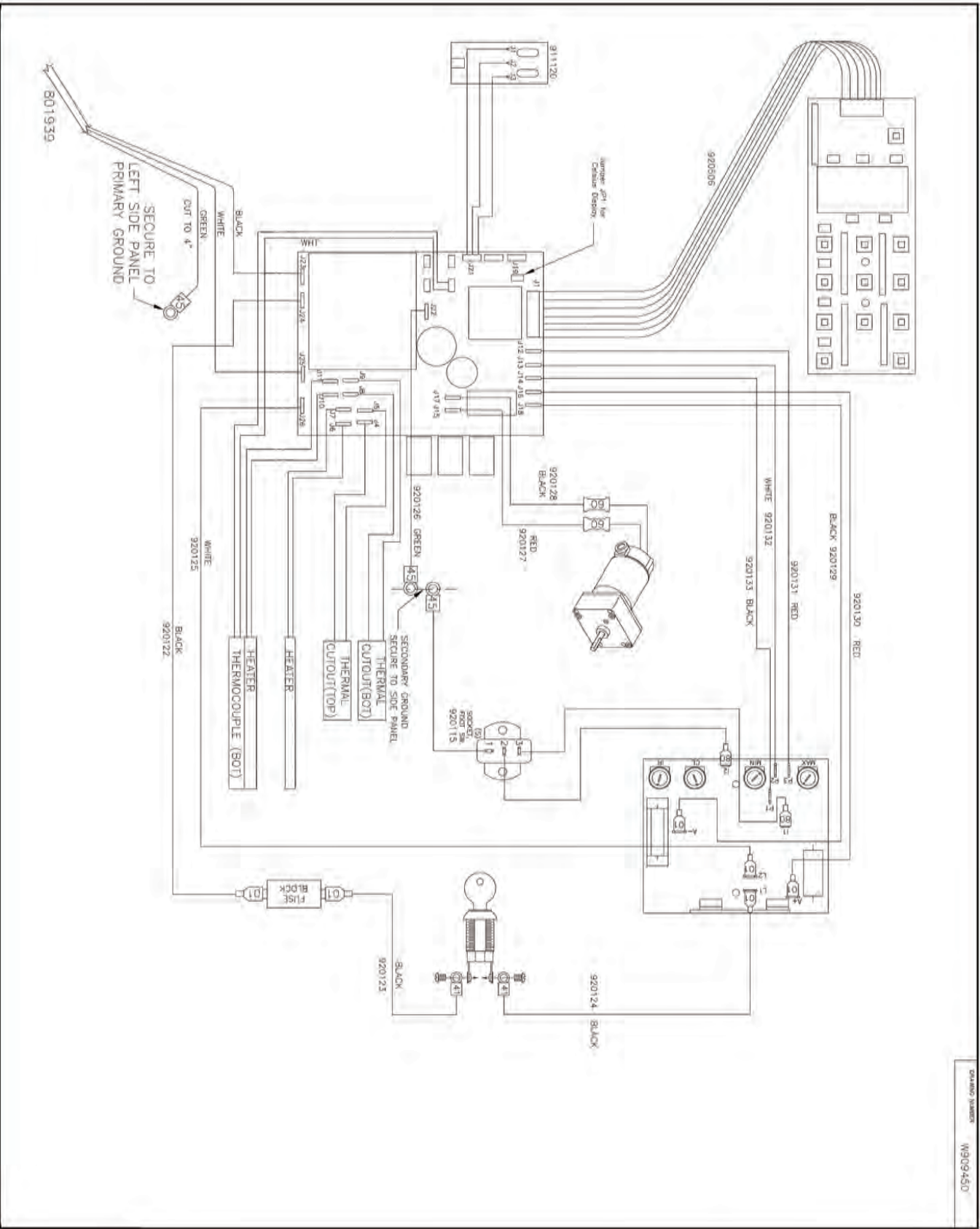

Shut the machine off! Minikote Pros have set screws at both ends of each pull roller. With the use of a 3/32 hex key, loosen all four set screws on the pull rollers. Cut the plastic between the laminating and pull rollers, grab the loose end and pull. The rollers will rotate freely on the roll shafts and the “wrap-around” will easily unwrap. Tighten all the set screws and rethread the film.

Appendix A

Replacing the hand held Cutter Blades.

The hand held cutter blade can be replaced by removing the small screw on the back of the cutter, then removing the cutter back. Caution: The cutter blade is extremely sharp. Please handle carefully and dispose of properly. Remove and discard the old blade. Re-install cutter back and screw. Caution: Do not over tighten screw.



IMPORTANT SAFEGUARDS

- Read all the safety and operating instructions before connecting or using this unit.
- Retain this notice and the owners manual for future reference.
- Adhere to all warnings and operating instructions.
- Do not use this unit near water (e.g. near a bathtub, etc.)
- The wearing of ties or jewelry while operating a laminator may be hazardous to the operator.
- Warning: Do not touch hot surfaces such as heated laminating rollers.
- This unit should be installed so that its location or position does not interfere with its proper ventilation. For example, it should not be situated on a bed, sofa, rug or similar surface that may block the ventilation openings; or placed in a built-in installation, such as bookcase or cabinet or against the wall, that may impede the flow of air through its ventilation openings.
- This unit should be situated away from heat and air ventilation systems such as radiators, heat registers, stoves, etc.
- This unit should only be connected to a power supply outlet of the voltage, amperage and frequency marked on its serial tag.
- For 120 volt machines the socket outlet shall be installed near the equipment and be easily accessible.
- The power supply cord should be routed so that it is not likely to be walked upon or pinched, especially near the plug, convenience receptacles, or where the cord exits from the unit.
- Unplug the machine during any machine repairs.
- Clean unit only as recommended in this instruction manual.
- Make sure to remove the Feed Table before reversing the machine!
- Care should be taken so that objects do not fall, and liquids are not spilled, into the enclosure through any openings.
- Caution: The Cutter blade is extremely sharp. Please handle carefully and dispose of properly.

GENERAL DIAGRAMS

The Minikote Pro offers variable speeds and a reverse feature. It is designed to laminate a variety of materials using up to 27" laminating films and adhesives. The Minikote Pro is capable of lamination from 1 to 9.5 feet per minute and can be reversed by the push of a button.

Tension Adjusting Knobs (A) are conveniently located on the Supply Mandrels (B) on the right side panel for easy access. A Control Panel (C) is located on the Left Housing (D) - (see page 4), and is equipped with a Power

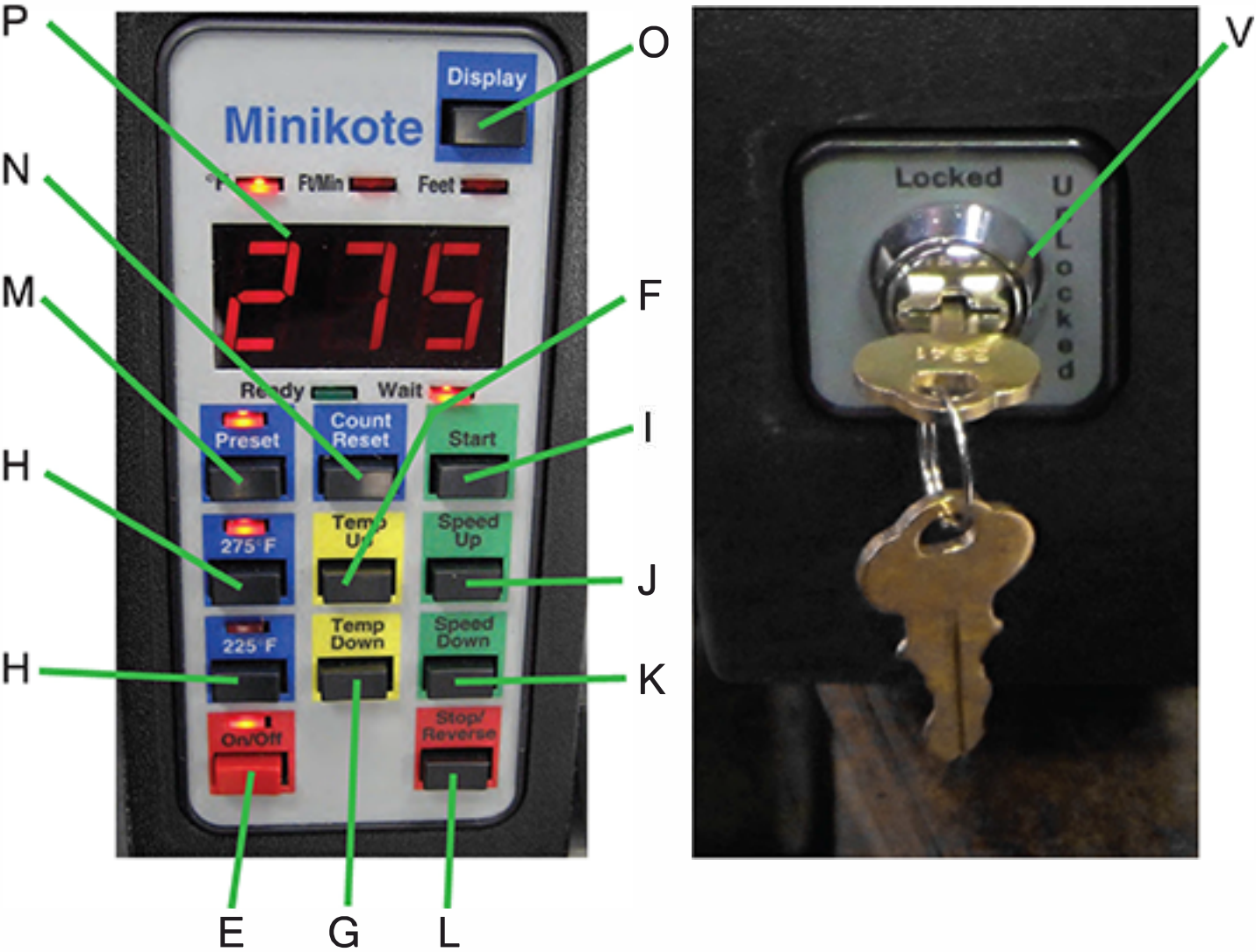

Button (E) to turn the machine on, Temperature Up (F) and Temperature Down (G) buttons, two Preset buttons (H), a Motor Start button (I) to start the motor turning, Speed Up (J) and Speed Down (K) buttons to adjust the speed as necessary, a Motor Stop/Reverse button (L), a User Preset button (M) to save your own settings, and a Count Reset button (N) which resets the usage counter. The Display button (O) toggles the Display (P) between 3 settings. The Feedtray (Q) and Feed Guide (R) provide a smooth, durable paper path and the Heat Guard (S) protects hands from hot surfaces inside. Silicone coated nip rollers (T) provide pressure to laminate and mount. The Cutter (U) cuts and trims your laminated documents and the Keyswitch (V) prevents unauthorized usage. Pull roller lift levers (W) open the pull rollers (X) on the back of the laminator to allow boards up to 1/4" thick pass through.

B. Specific Troubleshooting Guide

| | Increase Heat | Decrease Heat | Worn, Dirty, Or Damaged Rollers | Increase Tension On Supply Rolls | Dirty Rollers | Moist Or Coated Product | Decrease Tension On Supply Rolls | Reduce Speed | Check Threading Diagram |
|---------------------------------|---------------|---------------|---------------------------------|----------------------------------|---------------|-------------------------|----------------------------------|--------------|-------------------------|
| Wrinkles on Film (side to side) | | ● | ● | ● | | | | | |
| Wrinkles on Film (lengthwise) | | ● | | ● | | ● | | | |
| Plastic not bonding | ● | | | | | | ● | | |
| Bubbles or Blisters | | ● | ● | | ● | | | | |
| Impressions on product | | | ● | | | | | | |
| Squeaking sounds | | | | | | ● | | ● | |
| Film narrowing on shoes | | | | | | ● | | ● | |
| Film wrinkling on shoes | ● | | | ● | | | | | |
| Continuous blemish | | | ● | | ● | | | | |
| Cloudy film | ● | | | ● | | | | | |
| "Orange Peel" Finish | | ● | | | | | | | |
| Film sticks to nip rollers | | | ● | | | | | | ● |
| Film sticks to pull rollers | | | | ● | | | | | ● |
| Film won't stay aligned | | | | | | | | | ● |
| No seal on edges | ● | | | ● | | | ● | | |
| Poor seal - one side only | | | | | ● | | | | |

C. Removing a "Wrap-Around"

A "wrap-around" occurs if the film exiting the rear rollers curls around one of them causing the laminate to wind around the roller.

If the wrap-around is not severe, simply use the reverse feature and back the film out. Make sure to remove the Feed Table before reversing the machine!

For extreme wrap-arounds (i.e. when plastic and/or product have wrapped around the rubber rollers several times) follow this procedure:



V. Maintaining the Minikote Pro

A. Care and Cleaning

In the normal course of operating the Minikote Pro, dirt and adhesive will accumulate on the rubber rollers (Laminating produces static electricity which attracts airborne dust and dirt). Regular inspection and cleaning will assure that this does not become a problem.

Never use hard, sharp, or abrasive items to clean the rollers. The rollers are covered with a non-stick silicone surface that could easily be damaged. Any scratches, indentations, or marks left on the rollers will appear on the laminated product.

To clean the rollers, use a rubber roll cleaning eraser or a clean, lint-free cloth. Some suggested solvents are rubbing alcohol(isopropyl) or D&K Poly-Off. Cleaning the rollers while they are warm, BUT NOT HOT, softens adhesives and makes removal easier.

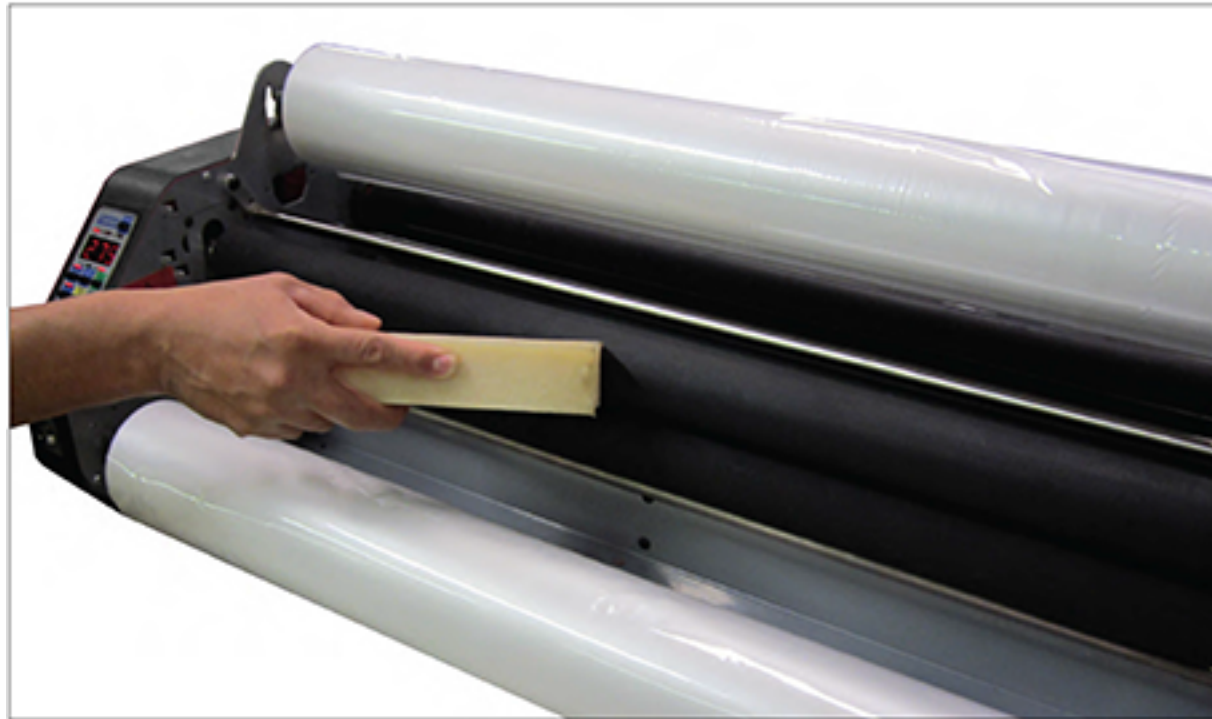

GENERAL DIAGRAMS

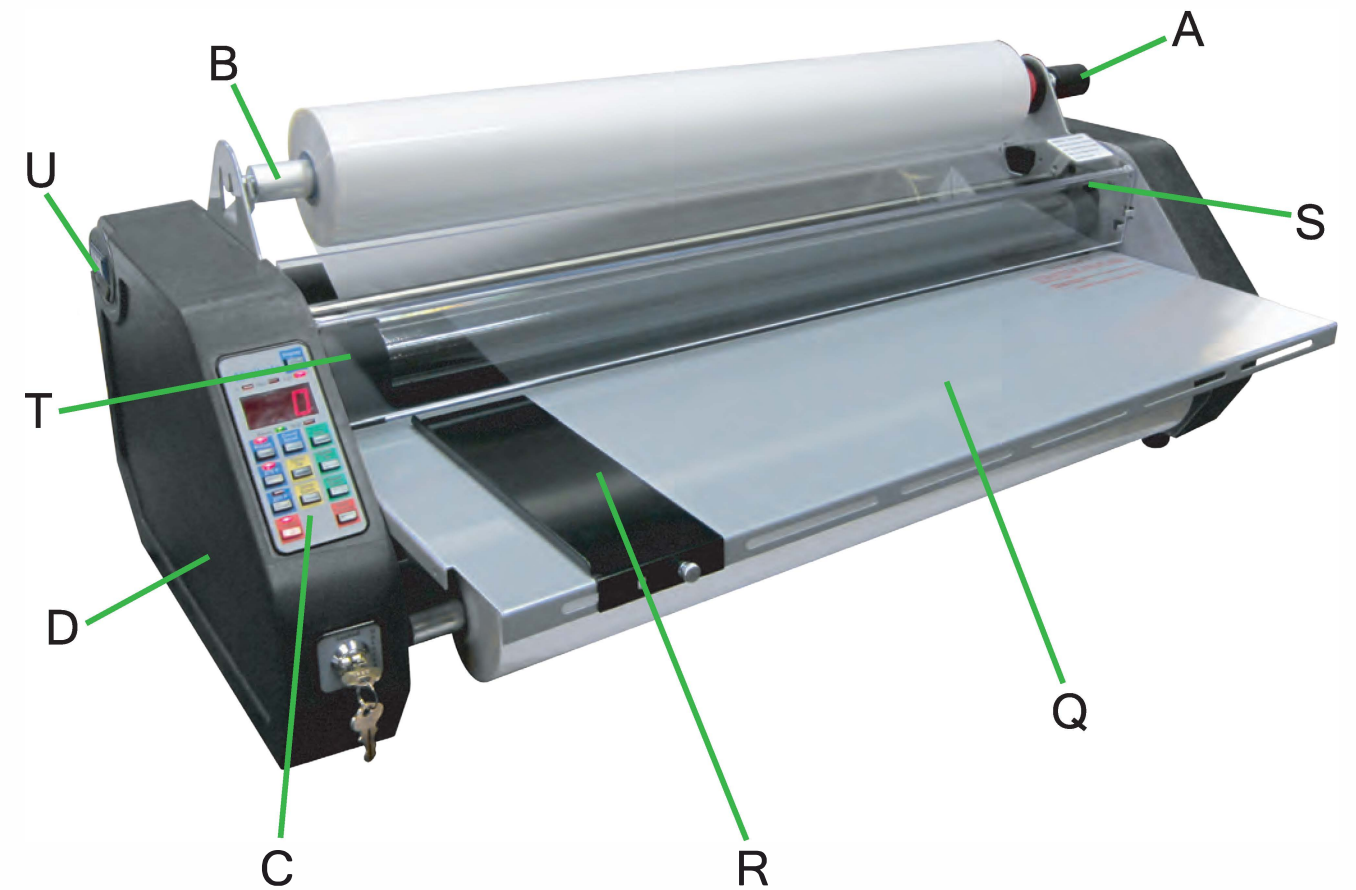

Back View

I. Unpacking

Remove the laminator from its box by grasping the housings and pulling up. Do not use rollers or shafts as handles - this could cause damage. Choose a location for the laminator that is clean, well-lit and draft free. Make sure it is not in the path of any fans, room air conditioners, or positioned too close to the wall. The laminator comes ready to load the film onto the supply mandrels, thread the film through the machine, and install the feedtable.

II. Information About Laminating Film

Laminating film is made up of two layers: a base film layer which provides protection, rigidity, and a gloss, matte or textured finish, and a dull or matte side which is heat activated and serves as the “glue” to bond the film to the product being laminated. Once heated, small amounts of the “glue” side can stick to the rollers and must be periodically cleaned from the laminator.

Laminating film is available in a variety of different lengths, and thicknesses. The Minikote Pro is designed to accommodate laminating films up to 10 mils thick.

III. Operating

A. Control Panel

The control panel is located on the left side of the laminator. This panel is used to control the various machine functions listed below.

Display (O,P)

The display of the Laminator will show the 3 different parameters of the machine: temperature, speed, and usage counter. The default display mode is usage counter. If the machine is not yet up to temperature, the machine will display the set point temperature. When the machine reaches the set point temperature, the usage counter will be displayed. If the speed is adjusted, the machine will momentarily display the speed and then quickly return to usage counter mode. The “Display” button allows you to toggle between any of the 3 settings for the display.

Power (E)

The “On/Off” button turns the machine on.

Heat (F,G)

The temperature controls are the “Temp Up” and “Temp Down” buttons (yellow blocks). These buttons are used to adjust the temperature currently displayed. The temperature displayed is the temperature set point. This is the temperature that the machine will reach and hold. The temperature can be increased or decreased in 1° increments by pressing and releasing the up or down button. To rapidly increase or decrease the temperature, press and hold the button. When the machine reaches the set point temperature, the Ready light (green) will illuminate, and a two second beep will sound. If a significant change in the set point temperature occurs, the Wait light (red) illuminates until the laminator reaches the new set point temperature. At this time the Ready light will illuminate again. Note: depending on room conditions and desired set point, it will take between 20 and 30 minutes for the ready indicator to come on.

Note: As the diameter of the film roll decreases, tension should be reduced.

To increase tension, turn the adjusting knob clockwise. To decrease tension, turn the knob counterclockwise. If the tension is not equal top and bottom, the laminated product will curl. If the material curls **up** as it comes out of the machine, the top roll is probably tighter than the bottom. If it curls **down**, the bottom roll is probably tighter.

Note: Make sure the black disks are flat against the sidepanel. They should be rotating, both top and bottom, while film is feeding.

F. Mounting

The Minikote Pro is capable of mounting onto foam boards and other rigid substrates up to 1/4” thick. The machine can also simultaneously laminate and mount prints when using an adhesive-coated substrate or a mounting adhesive.

In order to mount an image onto a substrate, the pull rollers on the back of the machine must be in the open or “up” position. This is accomplished by flipping up the pull roller lift lever on each side of the laminator. The levers feature a groove that locks the pull rollers in the “up” or “mounting” position once they are fully raised. To lower the pull rollers, flip each lift lever to the “down” or “laminating” position.



Down (Laminating) Position



Up (Mounting) Position

The front nip rollers are spring-loaded and automatically adjust to the thickness of the print or board that is being fed into the machine. To process a board through the laminator, place it on the feed table and position it so the leading edge is parallel to the nip rollers. Push the board into the nip rollers until they open up and accept the material. Once the rollers have engaged the board, it will feed through the machine and come out the back end.

D. Laminating

After the machine is loaded with film (see B. Loading Film: 1" Mandrel) and threaded (see C. Threading the Film), it is ready to laminate. Ensure that the laminator has reached the preset temperature. This will be indicated by the ready light being illuminated. Place document on the feedtable and align with the feedguide to assure straight and even lamination. Start the motor with the "Start" button and adjust the speed as necessary. If necessary, adjust the supply roll tension (see E. Supply Roll Tension Adjustment). With both hands, guide the document into the throat of the laminator. While the document is pulled into the laminating rollers, keep document flat on the feedtable while applying a slight back pressure. As the document exits the rear rollers, allow 3" to 6" of film to clear the rollers at the end of your document and turn the motor switch to stop. Using the hand held cutter, hold tension on the laminated document and slice through the film to release the document. Multiple documents can be run successfully if desired and cut at a later time.



E. Supply Roll Tension Adjustment (A)

Top and bottom supply rolls should have about the same tension. By turning the top roll with one hand, and the bottom roll with the other hand, it can be determined if one of the rolls is tighter than the other.

Note: Too much tension can destroy film, documents, and damage the machine.

Adjust the tension to the minimum amount required. Do this by loosening the tension knobs until there is no tension on the film. With the machine threaded and at operating temperature, turn the motor switch to forward and adjust the speed to the desired operating speed. Tighten the adjusting knobs only until the wrinkles in the film are removed.

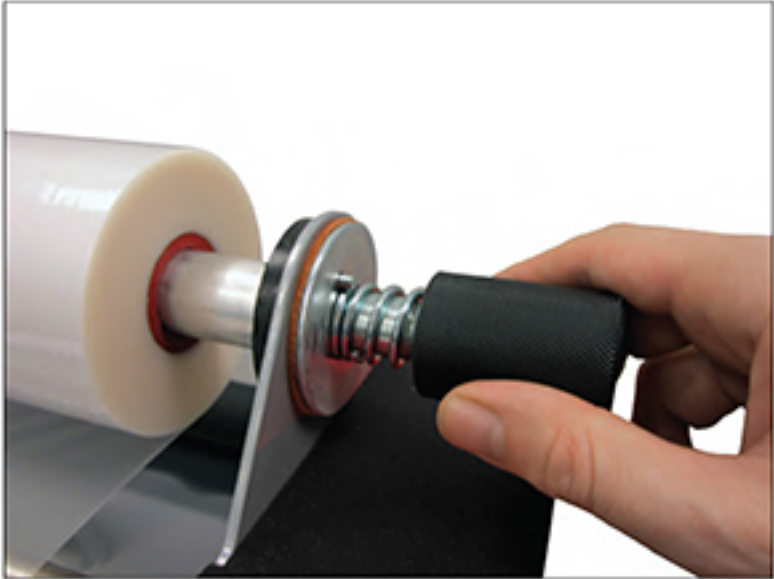

Standard Presets (H)

The Laminator is equipped with 2 factory presets. The buttons are labeled 275 and 225. These buttons will set both a speed and temperature, that being (275°F and 3 feet per minute) and (225°F and 3 feet per minute). If one of the presets is engaged, its corresponding LED will be illuminated.

Motor (I,J,K,L)

The motor controls are the 4 buttons on the right side of the control panel. The "Start" button will start the motor which will run at the current speed setting. The "Speed Up" and "Speed Down" buttons will adjust the speed setting. Pressing and releasing the button once will increment the speed by 0.1 ft/min (0.03 meters/min). To rapidly increase or decrease the speed, press and hold the corresponding button. To stop the motor, press and release the "Stop/Reverse" button. To reverse the machine, press and hold the "Stop/Reverse" button. The motor will remain in reverse as long as the button is depressed.

User Preset (M)

The laminator is equipped with a user defined "Preset" button. This button can be used to save a speed and temperature setting that you have defined. With the machine's speed and temperature set to your preferred settings, press and hold the "Preset" button until the beeper sounds and the preset light comes on. To recall this setting at a later time, press and release the "Preset" button.

Usage Counter (N)

The Laminator is equipped with a usage counter that will indicate the feet (meters) of film used. This counter will appear on the display whenever the feet indicator light is on. This counter can be reset to zero by pressing the "Count Reset" button once the display is showing the usage counter.

Additional Features

Keyswitch

The keyswitch (located just below the control panel) locks out the motor, allowing the machine to remain heated; yet, preventing unauthorized usage when in the locked position.

B. Loading Film: 1" Mandrel (B)

Unpack the upper and lower supply mandrels. The upper and lower mandrels are different. The word "TOP" is stamped on the shaft of the upper mandrel and the word "LOW" is stamped on the shaft of the lower mandrel. The ends of each mandrel are also different. The "hanger" end fits in the bracket on the left side of the laminator. The "slot end" fits into the tension adjuster on the right side.

Slide the film roll onto the mandrel by rotating the mandrel in the opposite direction of the gripper points, leaving equal lengths of mandrel sticking out of each end. The film roll will slide over the gripper, which will keep the roll from turning on the shaft.

D&K's Minikote Pro laminating films feature color-coded cores to facilitate loading. The film intended for the top roller contains a red core that corresponds to the red tension adjuster on the top of the machine. The bottom film supply features a blue core that corresponds to the blue tension adjuster on the bottom of the machine. The Minikote Pro is compatible with most films on the market, however these may not feature red and blue cores.

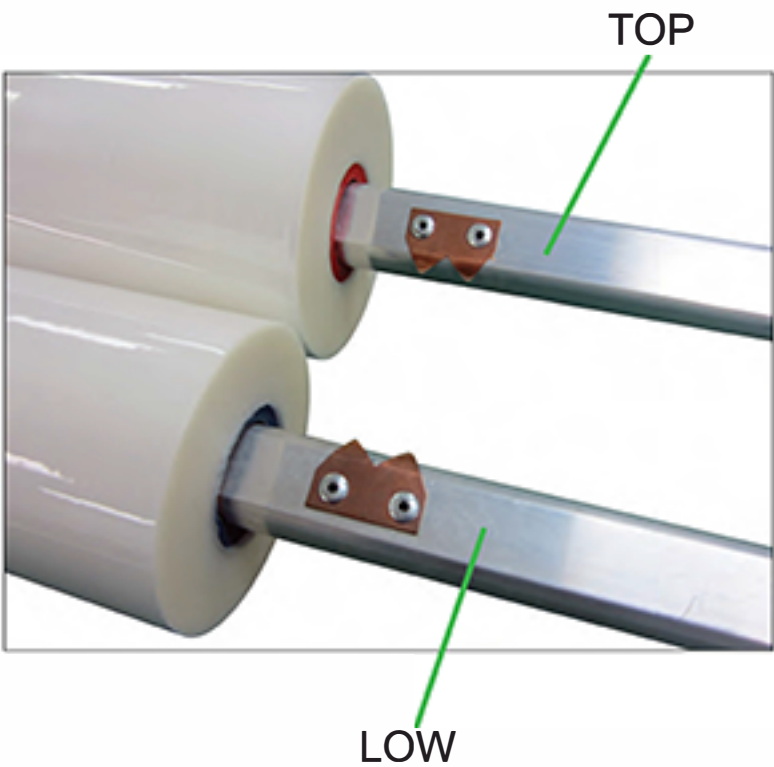

Load the mandrel on the laminator by inserting the slot end of the mandrel into the tension adjuster on the right side and then lowering the hanger end into the bracket on the left side.

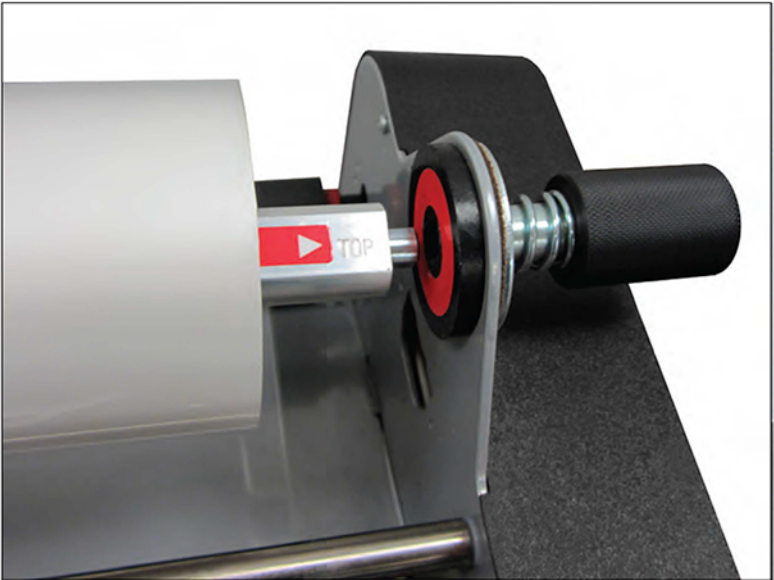

C. Threading the Film

Remove the feed tray and the heatguard. Thread the film as shown in the figure on the right. Pull the film around the idler rollers as shown. Unhook the lower idler roller and lower it down for easier threading. Raise it back up and hook into the locked position before threading the film between the heated rollers. Make sure the shiny and dull sides of the film are as indicated in the diagram. Position the threading board provided.

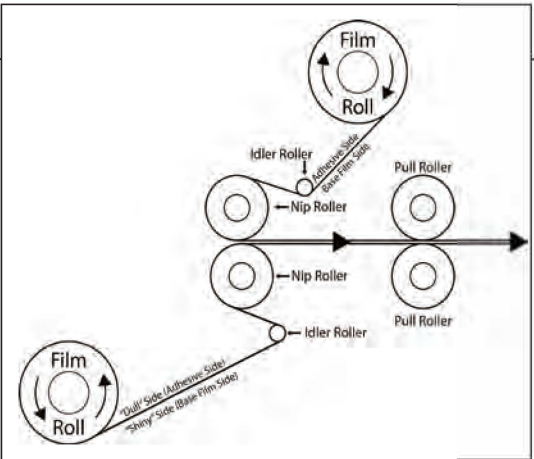

Turn power and keyswitch to on. Start the motor by pressing the "Start" button, and reduce the speed to 1 foot/min.

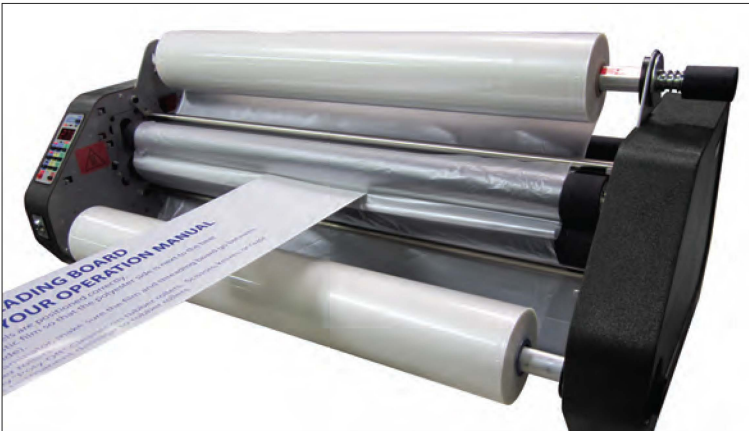

Feed the threading board and film between the front rollers. This will pull the film through the rear pull rollers until it comes out the back of the laminator.

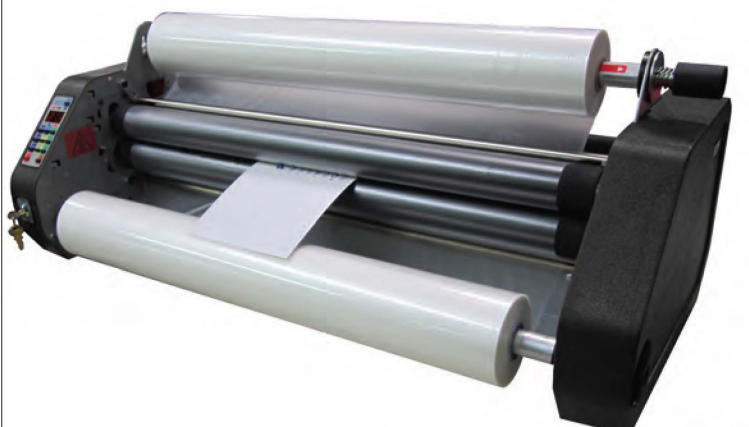

Slide the top and bottom film rolls from side to side on the mandrels so that the film is perfectly aligned top and bottom (Note: overlap will cause the film to deposit adhesive residue on the rollers, so this procedure is critical). Replace feed tray and heat guard.

